

UNIVERSAL

M O U N T I N G I N S T R U C T I O N S

REF 003N
003C

WINDSHIELD VISION MODEL



1 Person



15 min



EASY



Nº 10
Nº 13



ALLEN
Nº 3
Nº 4



No usar cola fijadora para tornillos al reaccionar con el plástico agrietándolo.

Do not use thread-lock glue on screws/nuts as it can produce cracking on the plastic.

Ne pas utiliser de colle de fixation pour les vis car elle réagit avec le plastique en le fissurant.



En las revisiones del vehículo es conveniente efectuar también el mantenimiento de apriete de toda la tornillería del carenabrís, especialmente los tornillos que fijan a éste al vehículo.

Gracias por su atención.

It would be convenient to re-tight the windshield screws, specially the ones that are fixed to the motorcycle, whenever you maintain the vehicle.

Thanks for your attention.

| ID | PIEZA/PART | DESCRIPCIÓN | DESCRIPTION | QTY | REF |
|----|------------|-------------------------------------|-------------------------------------|-----|-----------------------|
| 1 | | Cúpula | Screen | 1 | 1517A/F/H/ N/V/WM3 |
| 2 | | Carcasa | semifairing | 1 | 10156C/NM3 |
| 3 | | Silentblock M5 | M5 silentblock | 3 | SILENBTM5-046/1 |
| 4 | | Arandela nylon M5 | M5 nylon washer | 3 | ARNV00000000245 |
| 5 | | Tornillo ISO7380 M5x16 | M5x16 ISO7380 allen screw | 3 | TORNI-I7380-493 |
| 6 | | Tapon tornillo M5 | M5 screw cap | 3 | TAPON-----85 |
| 7 | | Ribete | Trim | 1 | RIBETEAHP--900H |
| 8 | | Soporte inox | Inox support | 2 | SOPORT2PIP2-006 |
| 9 | | Tornillo M6x8 ISO 7380 | M6x8 ISO 7380 screw | 4 | TORNIAI7380-300 |
| 10 | | Tornillo M6x12 DIN912 | M6x12 DIN912 screw | 2 | TORNIAD912-0230 |
| 11 | | Tuerca M6 DIN934 | M6 DIN 934 Nut | 2 | TUERCAEM6G-0213 |
| 12 | | Arandela de plástico Ø6,1 xØ11 x1mm | Ø6,1 xØ11 x1mm plastic washer | 4 | ARANDEPNVCN0246 |
| 13 | | Tuerca M8 DIN 6923 | M8 DIN 6923 nut | 2 | TUERCEG6923-249 |
| 14 | | Tornillo M8x35 DIN 912 | M8x35 DIN 912 screw | 2 | TORNI-AD912-196 |
| 15 | | Arandela plana Ø18 xØ8 x1,5mm | Ø18 xØ8 x1,5mm flat washer | 2 | ARANDPD125A-018 |
| 16 | | Casquillo Ø15 xØ8 x9mm | Ø15 xØ8 x9mm Arrowhead | 2 | CASQUI8159-0266 |
| 17 | | Casquillo Ø12 xØ6 x8,5mm | Ø12 xØ6 x8,5mm Arrowhead | 2 | CASQUI-----0298 |
| 18 | | Tornillo M6x20 DIN 912 | M6x20 DIN912 Screw | 2 | TORNI-AD912-489 |
| 19 | | Adhesivo microporoso 30x30x7mm (**) | 30x30x7mm microporous adhesive (**) | 2 | ADHESI-M30DX7-- |

UNIVERSAL

INSTRUCCIONES DE MONTAJE - MOUNTING INSTRUCTIONS - MONTAGEANLEITUNG

1

ASSEMBLY
MONTAJE

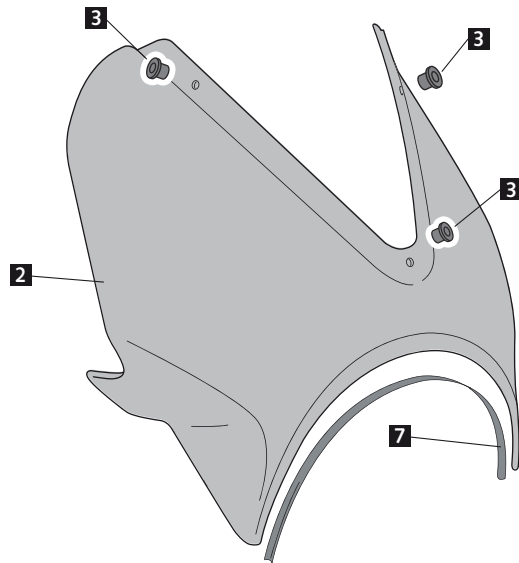

2

ASSEMBLY
MONTAJE

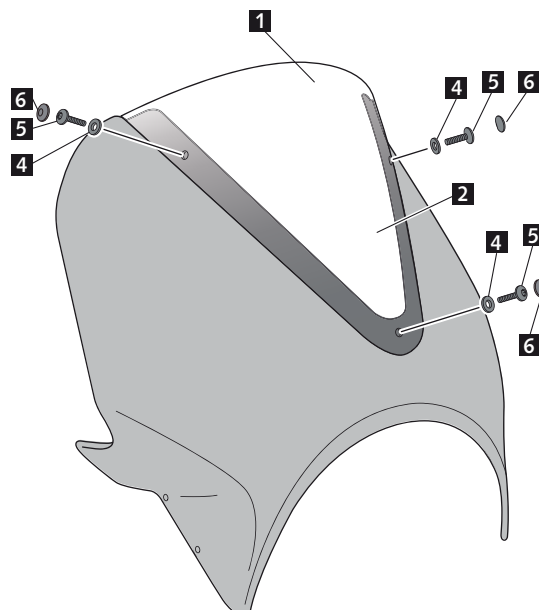

UNIVERSAL

INSTRUCCIONES DE MONTAJE - MOUNTING INSTRUCTIONS - MONTAGEANLEITUNG

