

HARLEY DAVIDSON PAN AMERICA RA1250 '21-

M O U N T I N G I N S T R U C T I O N S

VIDEO

REF 21334

REINFORCEMENT SUPPORT



TORX
T30

ALLEN
Nº 3
Nº 4

Nº 10

ID	PIEZA/PART	DESCRIPCIÓN	DESCRIPTION	QTY	REF
1		Soporte derecho	Right support	1	SOPOR4P9-R21334
2		Soporte izquierdo	Left support	1	SOPOR4P9-L21334
3		Soporte cúpula derecho	Right screen support	1	SOPOR4P9CR21334
4		Soporte cúpula izquierdo	Left screen support	1	SOPOR4P9CL21334
5		Varilla aluminio	Aluminum guide	1	SOP6P14V---20507
6		Casquillo con valona Ø12xØ6,8x7,3	Ø12xØ6,8x7,3 Bush with flange	2	CASQUI-1A---750
7		Arandela de nylon Ø13XØ8X1	Ø13XØ8X1 Nylon washer	2	ARAND-N-----265
8		Tornillo M5x16 Ø11 ISO 7380	M5x16 Ø11 ISO 7380 allen screw	2	TORNI-I7380-493
9		Tuerca autoblocante M5 DIN982	M5 DIN982 Nut	2	TUERCA-D982-746
10		Tornillo Allen M6x10 Ø14 ISO 7380	M6x10 Ø14 ISO 7380 Allen screw	2	TORNI-I7380-402
11		Arandela Grower DIN127 M6	DIN127 M6 grower washer	1	ARAND-D127--528
12		Arandela especial Ø7x Ø16x 6 mm	Ø7x Ø16x 6 mm special washer	1	ARAND-----21334
13		Arandela de nylon M5	M5 Nylon washer	2	ARNV00000000245

HARLEY DAVIDSON PAN AMERICA RA1250 '21-

INSTRUCCIONES DE MONTAJE - MOUNTING INSTRUCTIONS - MONTAGEANLEITUNG

5

ASSEMBLY
MONTAJE

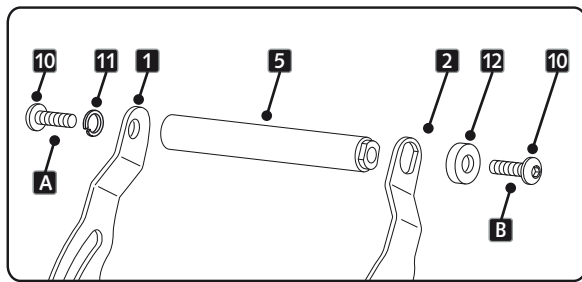

A Par de apriete - 4,5 Nm
Tightening torque - 4,5 Nm

B Par de apriete - 3,5 Nm
Tightening torque - 3,5 Nm

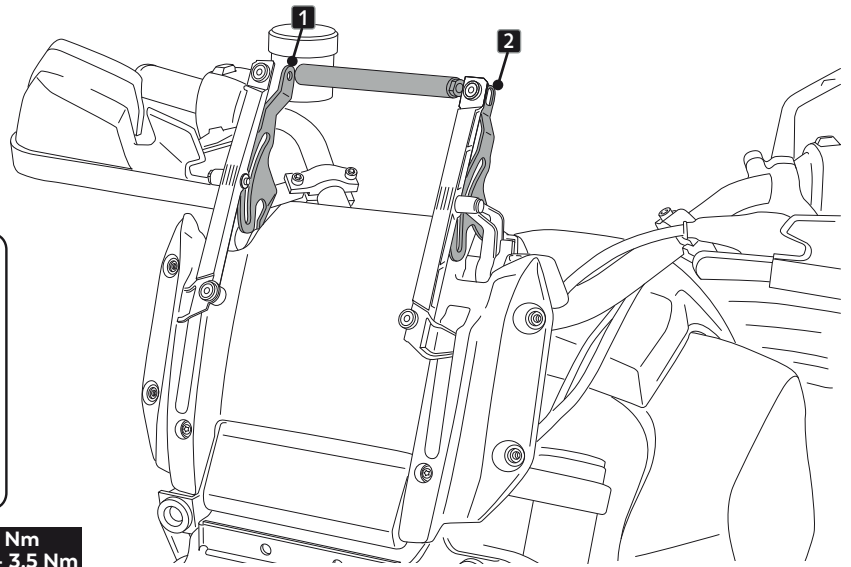

6

ASSEMBLY
MONTAJE

8 Par de apriete - 1 Nm
Tightening torque - 1 Nm

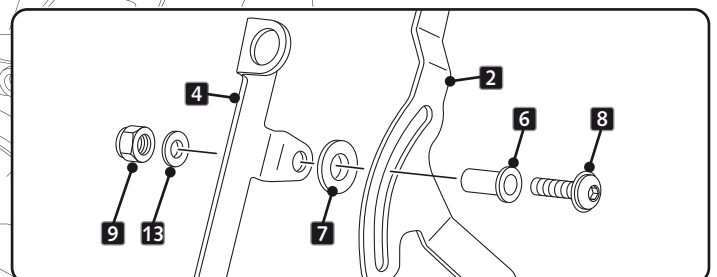
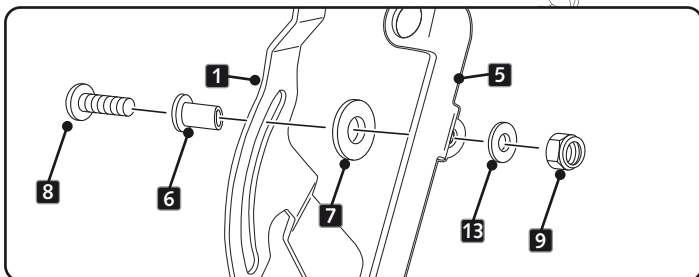
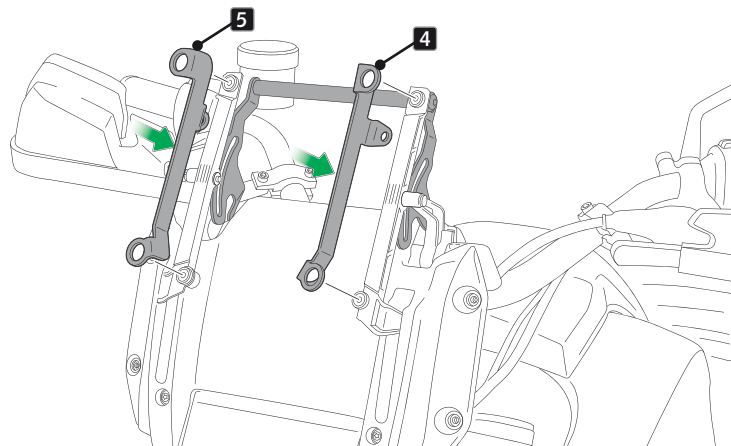

HARLEY DAVIDSON PAN AMERICA RA1250 '21-

INSTRUCCIONES DE MONTAJE - MOUNTING INSTRUCTIONS - MONTAGEANLEITUNG

7

ASSEMBLY
MONTAJE

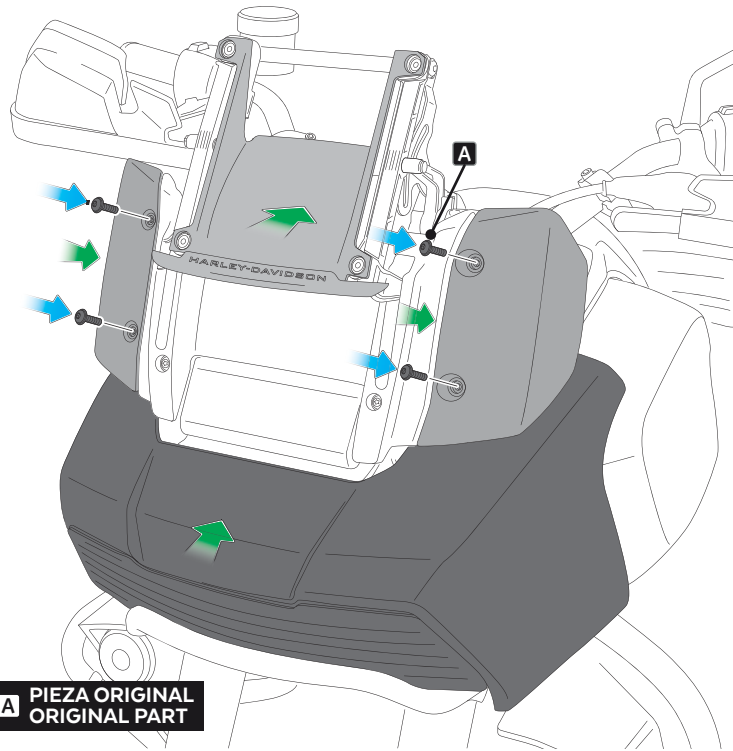

A PIEZA ORIGINAL
ORIGINAL PART

8

ASSEMBLY
MONTAJE

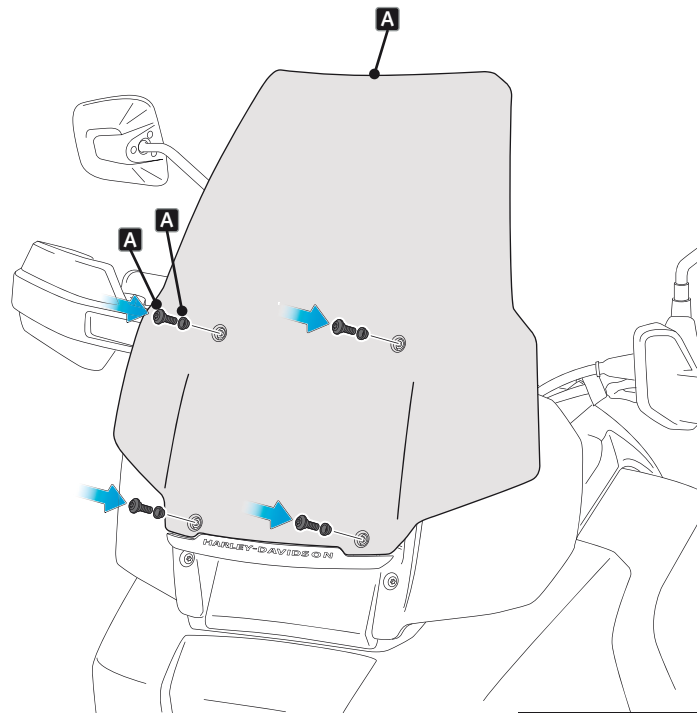

A PIEZA ORIGINAL
ORIGINAL PART