

# TRIUMPH TIGER SPORT 660 '22

## M O U N T I N G I N S T R U C T I O N S

REF 21542

REINFORCEMENT SUPPORT



1 Person



25 min



EASY



Nº 12



ALLEN

Nº 3  
Nº 5

ID	PIEZA/PART	DESCRIPCIÓN	DESCRIPTION	QTY	REF
1		Soporte fijo	Fixed support	1	SOP1P2----21317
2		Tornillo Allen M5x25 Ø11 ISO 7380	M5x25 Ø11 ISO 7380 Allen screw	2	TORNI-I7380-766
3		Casquillo Ø8,5 xØ13 x3,5	Ø8,5 xØ13 x3,5 arrowhead	2	CASQUI-----775
4		Palanca de bloqueo	Locking lever	2	PALANCA---21317
5		Tornillo Allen M5x30 Ø11 ISO 7380	M5x30 Ø11 ISO 7380 Allen screw	2	TORNI-I7380-767
6		Casquillo con valona Ø12xØ6,8x7,3	Ø12xØ6,8x7,3 bush with flange	2	CASQUI-1A---750
7		Arandela de nylon Ø13XØ8X1	Ø13XØ8X1 nylon washer	2	ARAND-N-----265

# TRIUMPH TIGER SPORT 660 '22

INSTRUCCIONES DE MONTAJE - MOUNTING INSTRUCTIONS - MONTAGEANLEITUNG

1

DISASSEMBLY  
DESMONTAJE

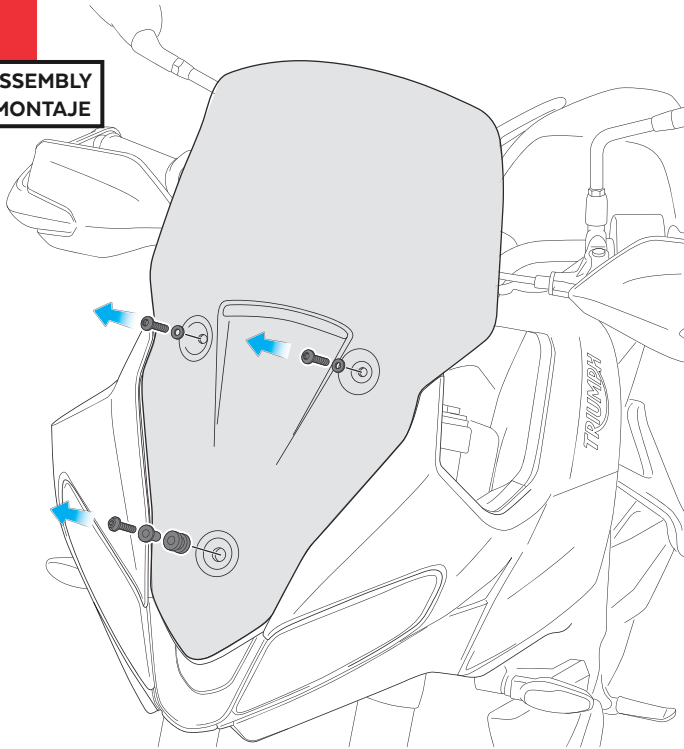

2

DISASSEMBLY  
DESMONTAJE

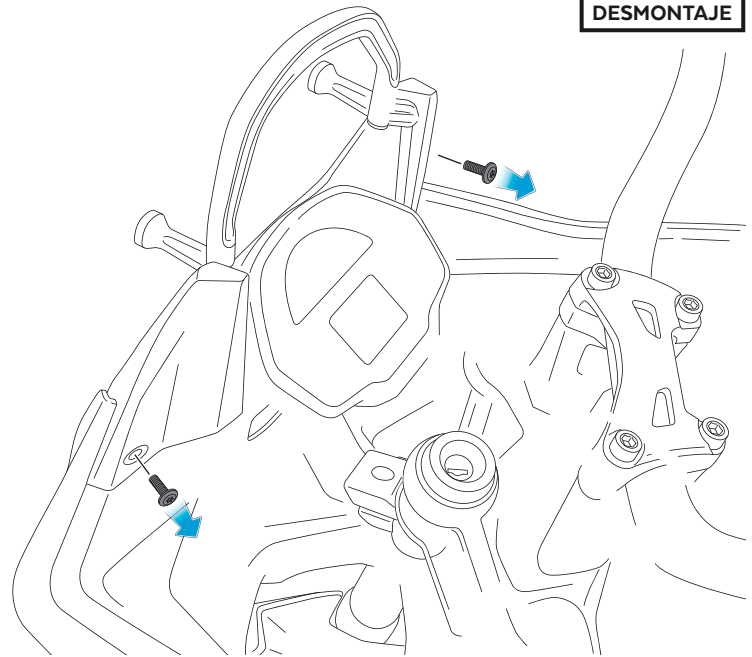

3

DISASSEMBLY  
DESMONTAJE

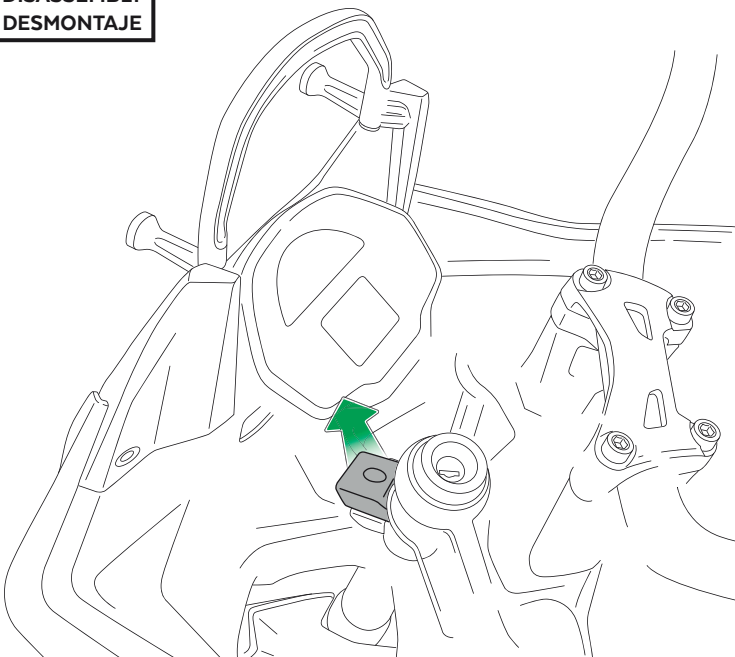

4

DISASSEMBLY  
DESMONTAJE

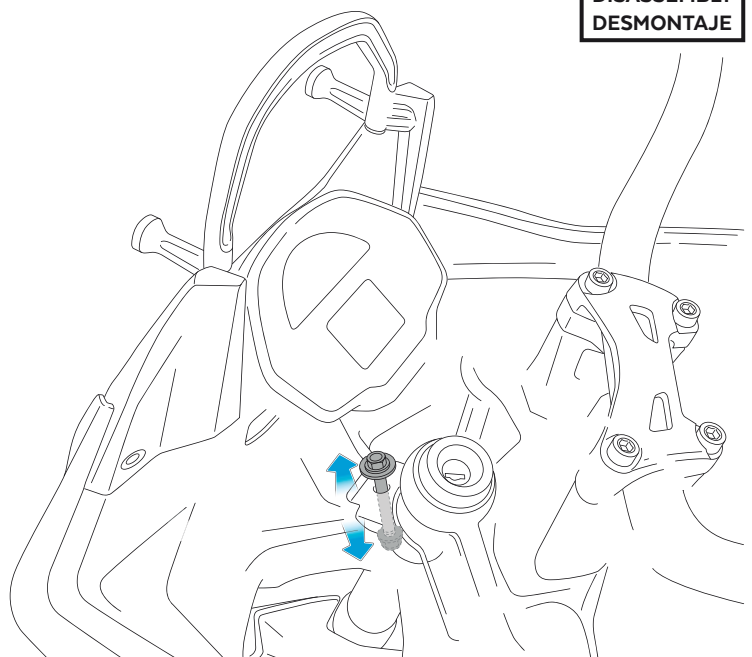

# TRIUMPH TIGER SPORT 660 '22

INSTRUCCIONES DE MONTAJE - MOUNTING INSTRUCTIONS - MONTAGEANLEITUNG

**5**

ASSEMBLY  
MONTAJE

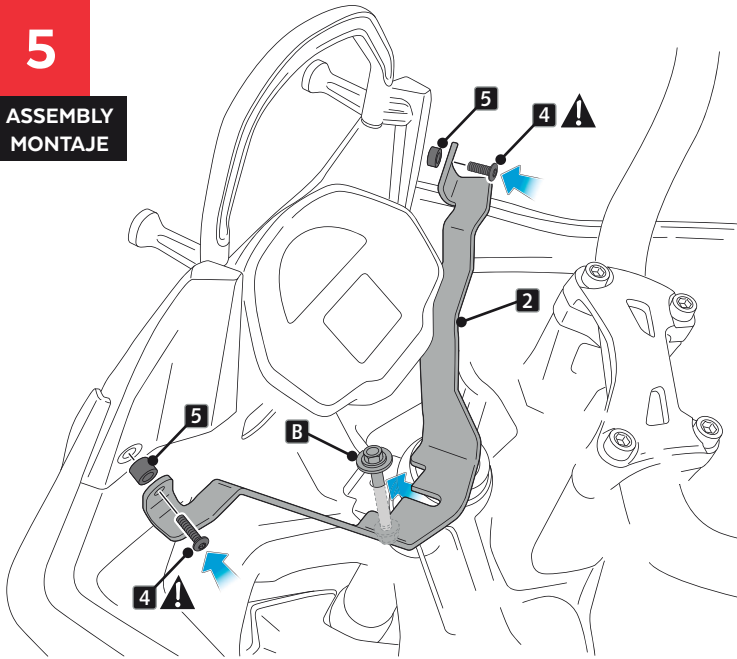

**B** TORNILLO ORIGINAL  
ORIGINAL SCREW

**!** **4** NO APRETAR  
DO NOT TIGHTEN

**6**

ASSEMBLY  
MONTAJE

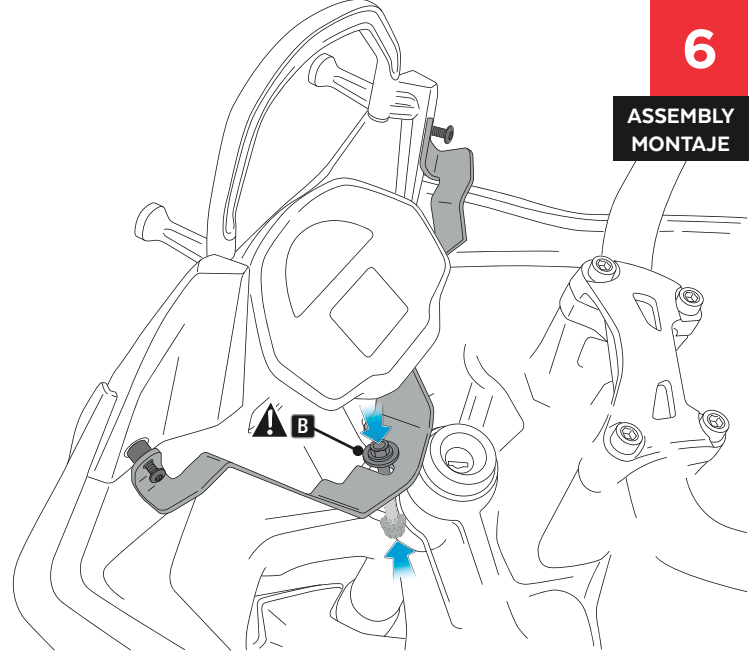

**B** TORNILLO ORIGINAL  
ORIGINAL SCREW

**!** **B** NO APRETAR  
DO NOT TIGHTEN

**7**

ASSEMBLY  
MONTAJE

**!**  
**STEP 1.**  
APRETAR TORNILLOS ID4 / TIGHTEN ID4 SCREWS  
**STEP 2.**  
ASEGURAR LA CORRECTA POSICIÓN DEL SOPORTE  
Y APRETAR TORNILLO ORIGINAL /  
ENSURE THE CORRECT POSITION OF THE SUPPORT  
AND TIGHTEN THE ORIGINAL SCREW.

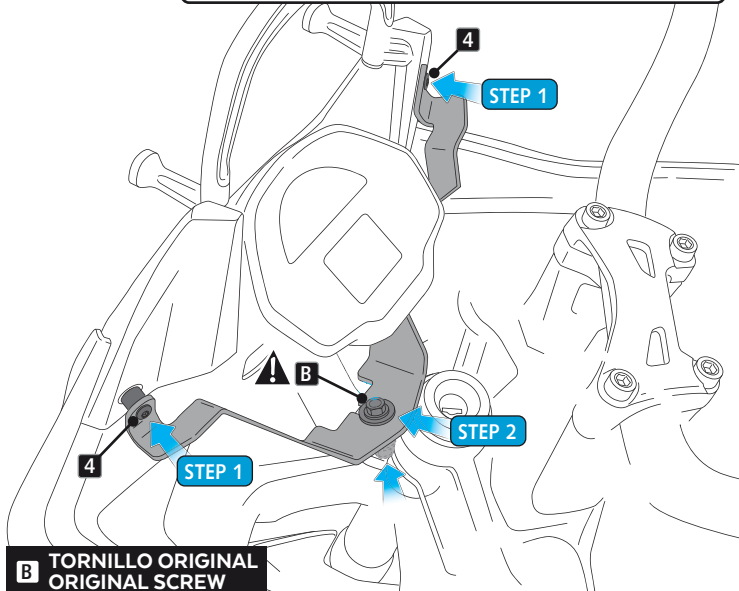

**B** TORNILLO ORIGINAL  
ORIGINAL SCREW

**8**

DISASSEMBLY  
DESMONTAJE

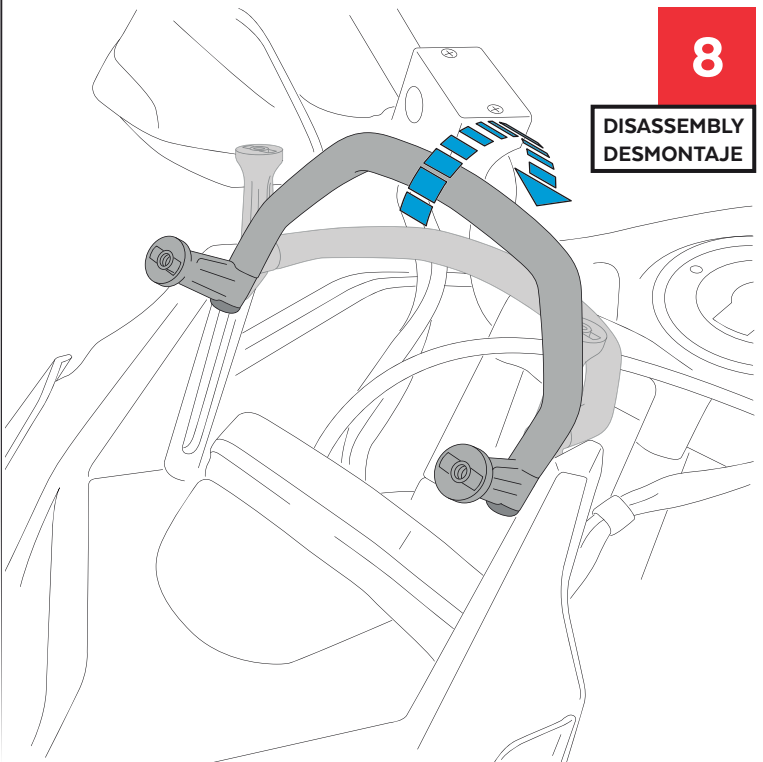

# TRIUMPH TIGER SPORT 660 '22

INSTRUCCIONES DE MONTAJE - MOUNTING INSTRUCTIONS - MONTAGEANLEITUNG

**9**

DISASSEMBLY  
DESMONTAJE

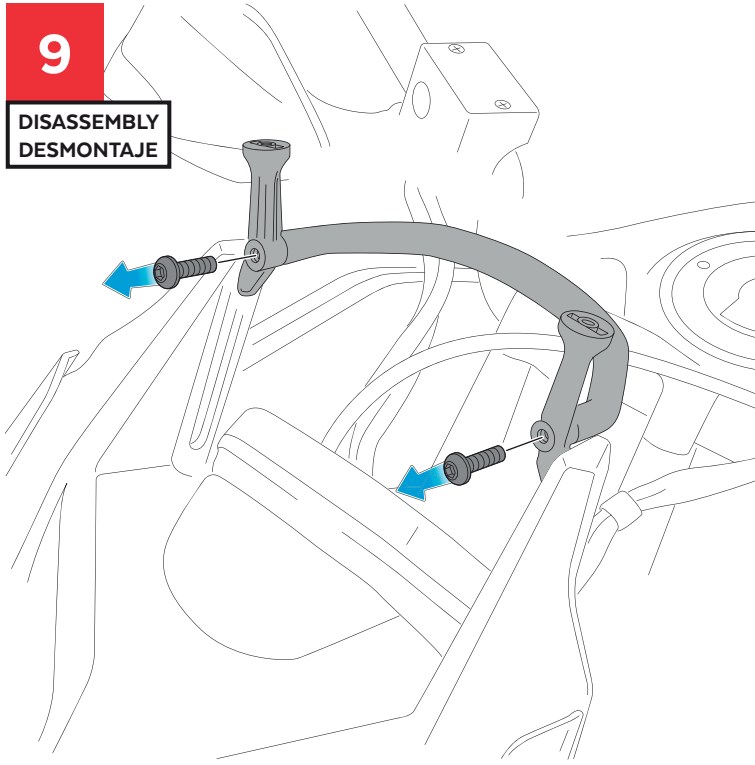

**10**

ASSEMBLY  
MONTAJE

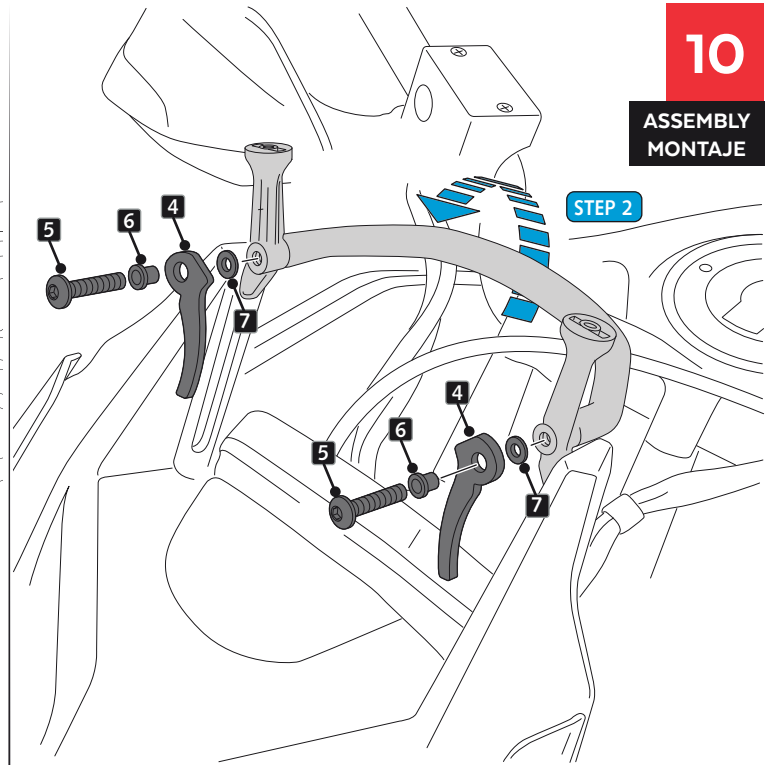

**11**

ASSEMBLY  
MONTAJE

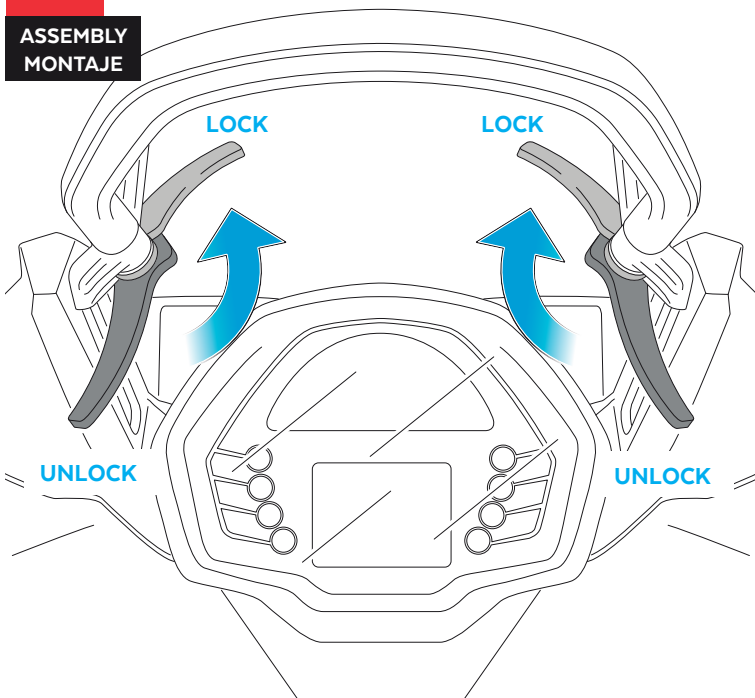

**12**

ASSEMBLY  
MONTAJE

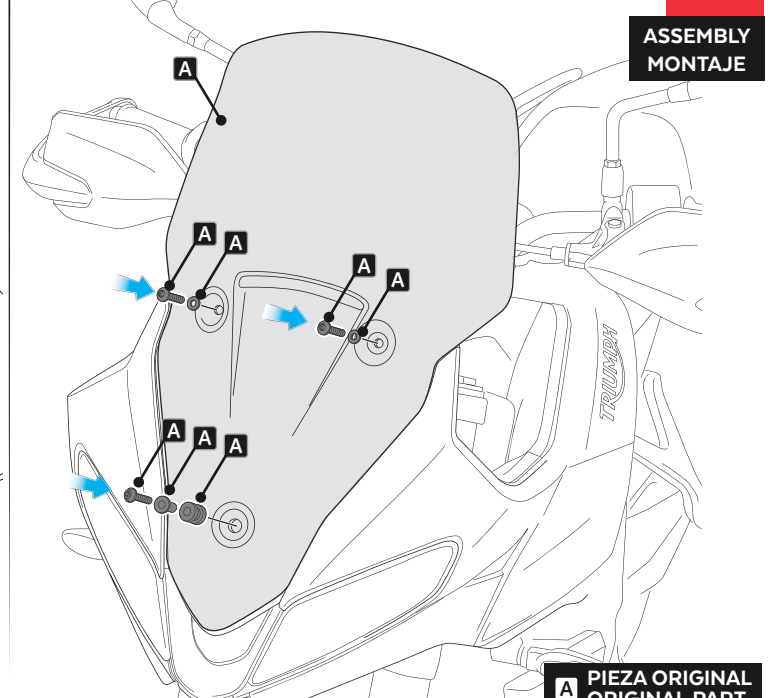

**A** PIEZA ORIGINAL  
ORIGINAL PART