

CF MOTO NK 450 '24-

MOUNTING INSTRUCTIONS

REF 2184N

PROTECTOR BASCULANTE PHB19 / PHB19 PROTECTOR SWINGARM

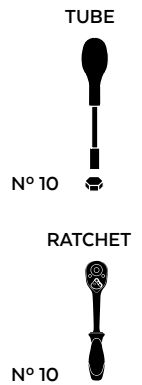

ID.	PIEZA / PART	QTY.	REF.:
1		1	PROBAS82-0-0082
2		1	PROBAS81-0-0081
3		1	VARIFO09-1-0009
4		2	TUZBM6000000024
5		2	ARANDEPD125-054
6		2	TAPAFINALR17-18

CF MOTO NK 450 '24-

REF
21884N

INSTRUCCIONES DE MONTAJE - MOUNTING INSTRUCTIONS - MONTAGEANLEITUNG

1

ASSEMBLY
MONTAJE

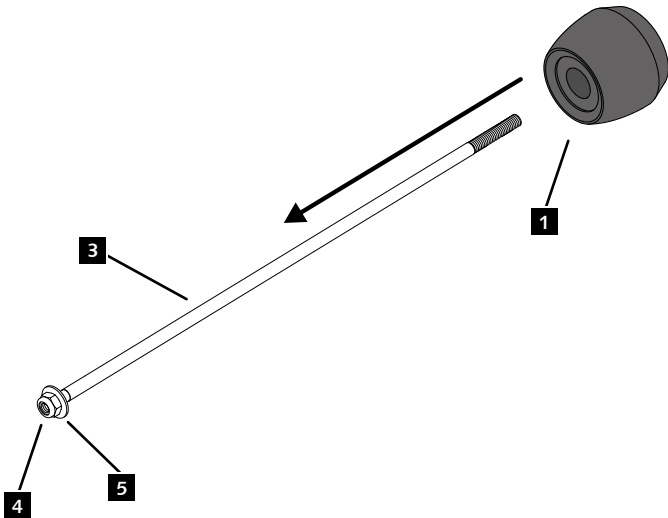

2

ASSEMBLY
MONTAJE

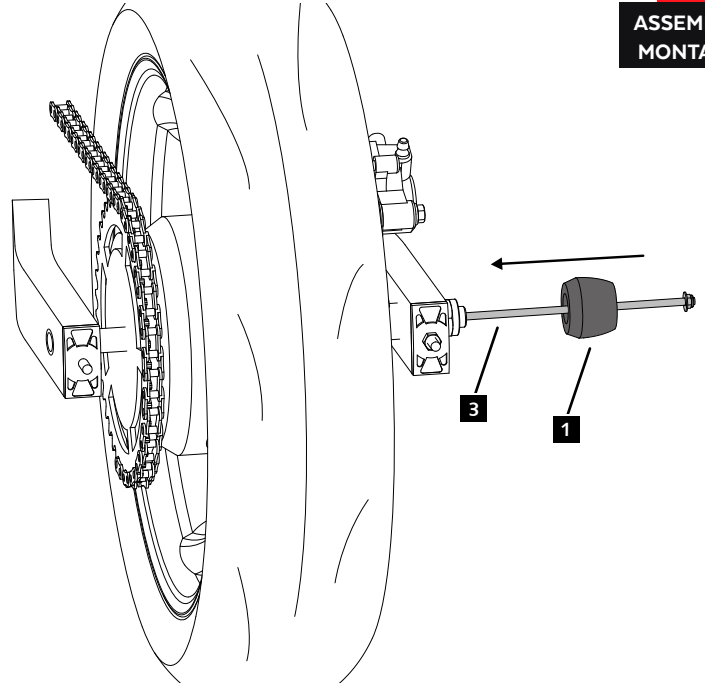

3

ASSEMBLY
MONTAJE

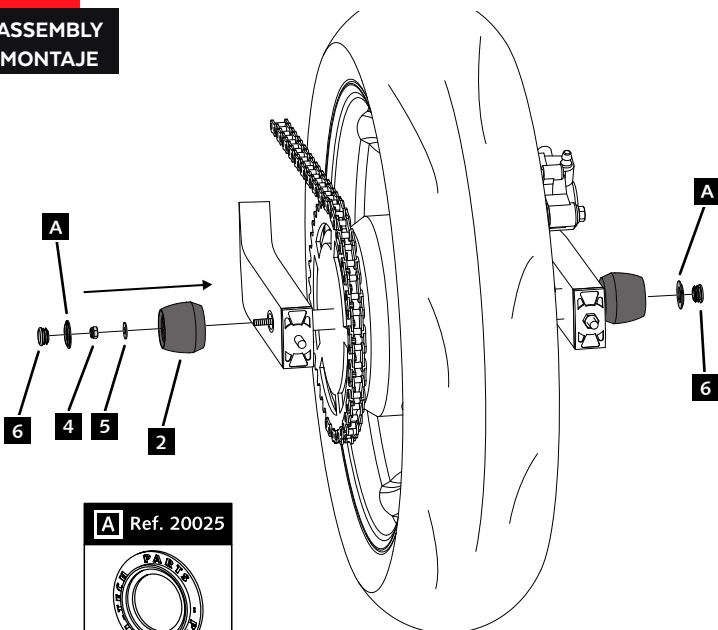

A Ref. 20025



4



9.7 N/m - Par de apriete
86 lbf/in - Tightening torque

CONSULTAR EN NUESTRA PAGINA WEB LA
DISPONIBILIDAD DEL VIDEO DE MONTAJE DE
ESTA REFERENCIA.
CONSULT OUR WEBSITE THE VIDEO MOUNT
AVAILABILITY OF THIS REFERENCE.

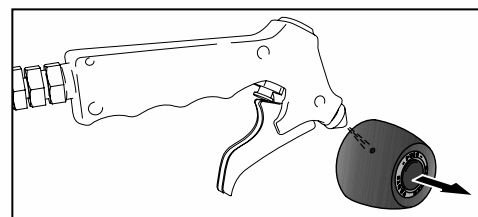

6

Extracción del tapón / Removing the cap